

Central Lakes College - Brainerd Campus

Lower Level

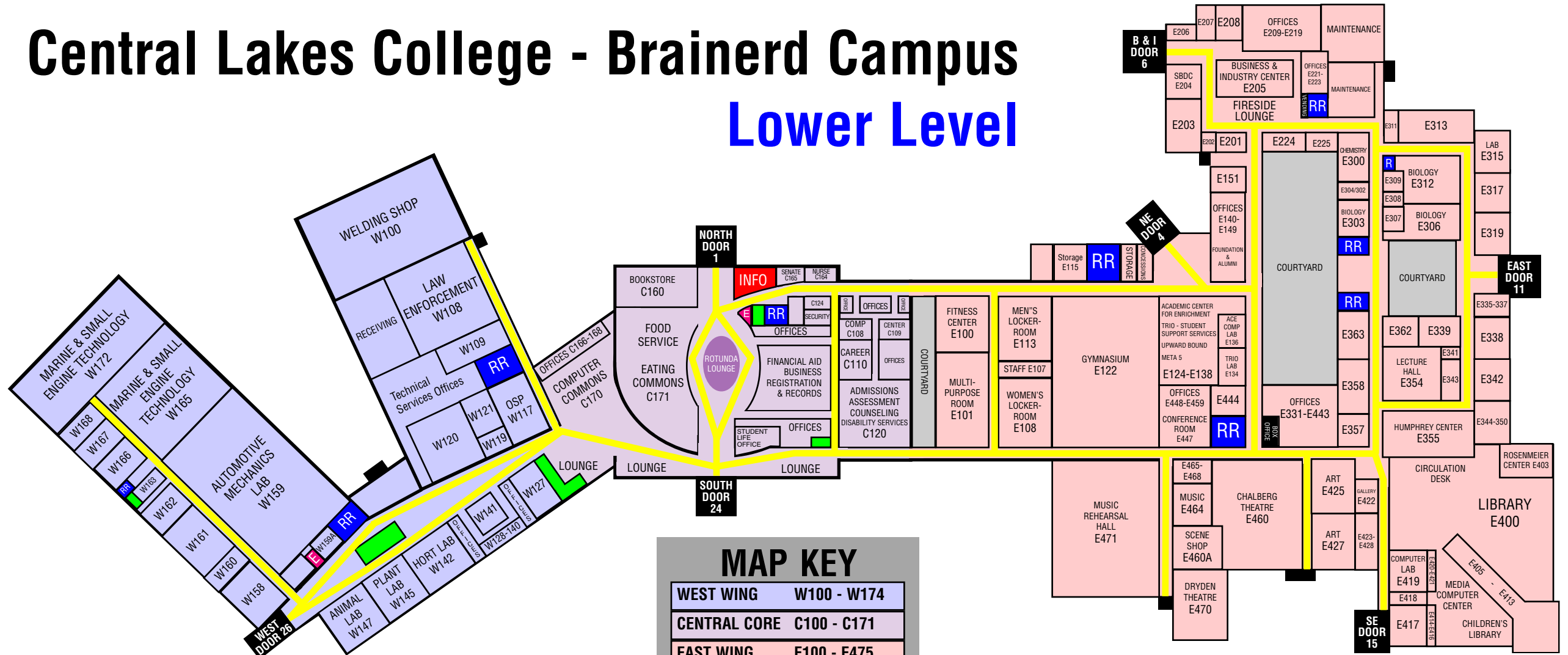

MAP KEY

WEST WING W100 - W174

CENTRAL CORE C100 - C171

EAST WING E100 - E475

MAIN DOORS

STAIRWAYS

REST ROOMS RR

ELEVATORS E

MAIN HALLWAYS

INFORMATION DESK INFO

CLC is committed to a policy of nondiscrimination in employment and education opportunity. No person shall be discriminated against in the terms and conditions of employment, personnel practices, or access to and participation in, programs, services, and activities with regard to race, sex, color, creed, religion, age, national origin, disability, marital status, status with regard to public assistance, sexual orientation, or membership or activity in a local commission as defined by law. This information is available in alternative format upon a 48-hour advance request by contacting Paula Huss in Disability Services, office C111 at 800-933-0346 ext 8175. Deaf and Hard of Hearing users or TTY communication contact the Minnesota Relay Service at 7-1-1 or 1-800-627-3529.

Central Lakes College - Brainerd Campus

Upper Level

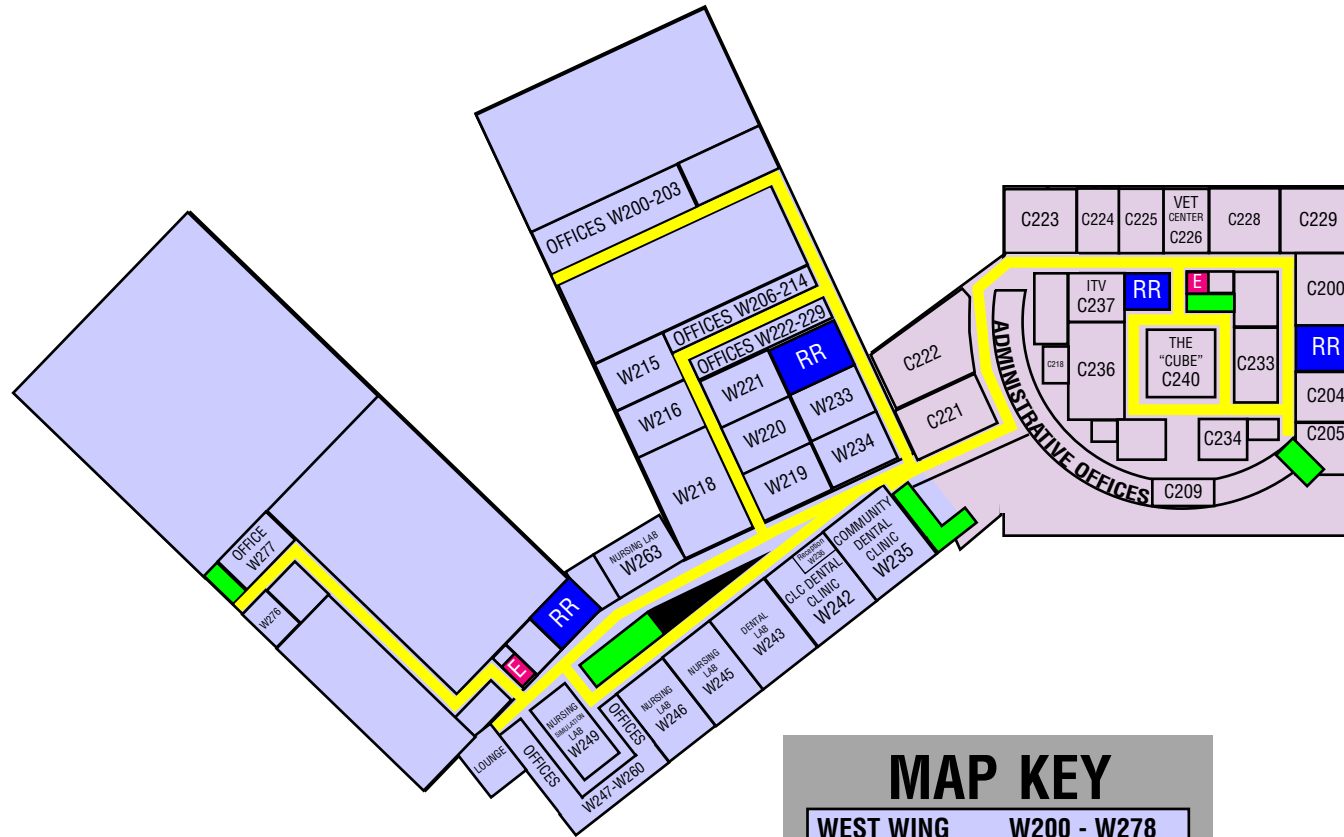

MAP KEY	
WEST WING	W200 - W278
CENTRAL CORE	C200 - C240
STAIRWAYS	
REST ROOMS	RR
ELEVATORS	E
MAIN HALLWAYS	

CLC is committed to a policy of nondiscrimination in employment and education opportunity. No person shall be discriminated against in the terms and conditions of employment, personnel practices, or access to and participation in, programs, services, and activities with regard to race, sex, color, creed, religion, age, national origin, disability, marital status, status with regard to public assistance, sexual orientation, or membership or activity in a local commission as defined by law. This information is available in alternative format upon a 48-hour advance request by contacting Paula Huss in Disability Services, office C111 at 800-933-0346 ext 8175. Deaf and Hard of Hearing users or TTY communication contact the Minnesota Relay Service at 7-1-1 or 1-800-627-3529.



Central Lakes College
 501 West College Drive
 Brainerd MN 56401
www.clcmn.edu
 800-933-0346 • 218-855-8000

